

PortaLite 60"/72"



PROJECTAI

Instructions for use

Gebrauchsanleitung

Mode d'emploi

Gebruiksaanwijzing

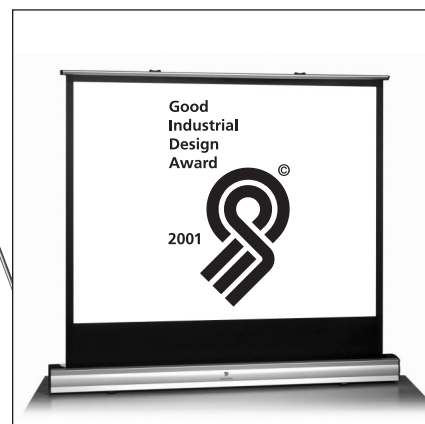

Dimensions

Screen size in cm	Viewing size in cm	Nominal diagonal inches/cm	Screen fabrics		Case dimensions			(A) Max. height in cm	(B) Viewing height in cm	Weight in kg
			Matte white S art.nr.	Datalux S art.nr.	H	W	L			
PortaLite - formaat 4:3										
118x131	94x126	60"/152cm	PSTPL 003	PSTPL 004	85	105	1426	186	88	8
138x151	110x146	72"/183cm	PSTPL 005	PSTPL 006	85	105	1626	215	102	9

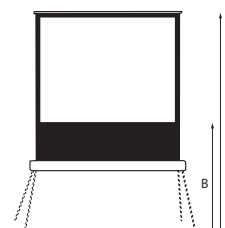

Accessory

60" = PBAHO 011
72" = PBAHO 012



Instructions for use

Use

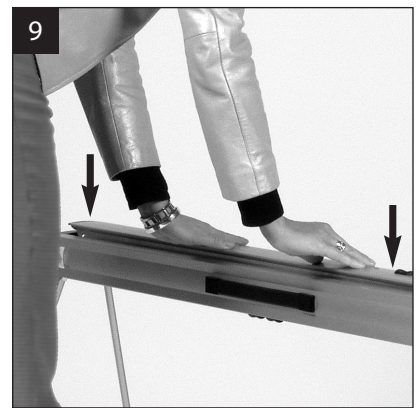
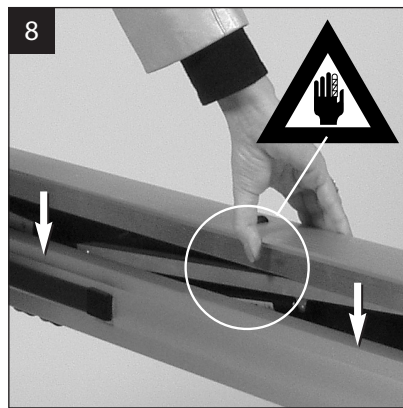
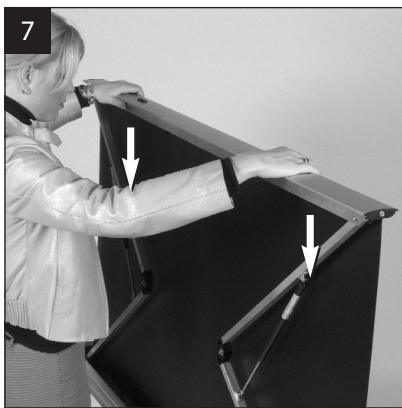
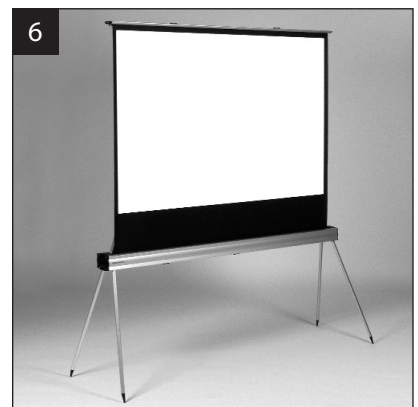
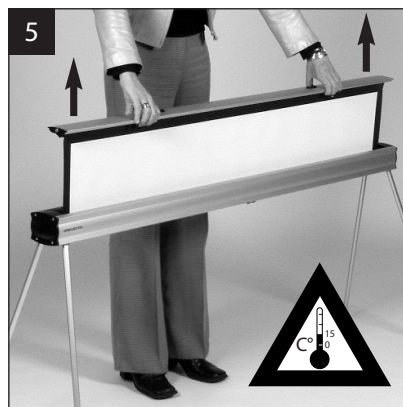
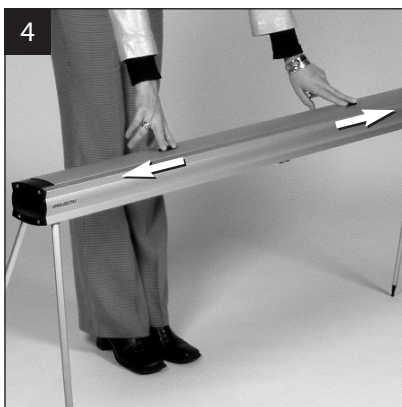
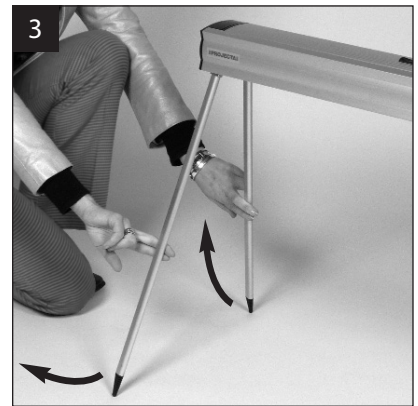
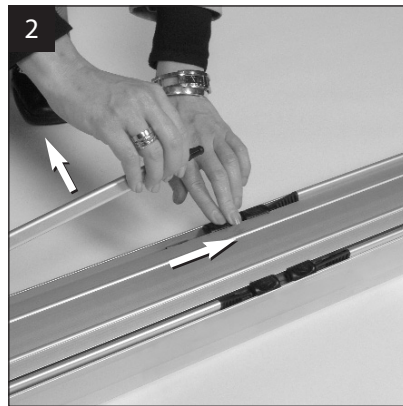
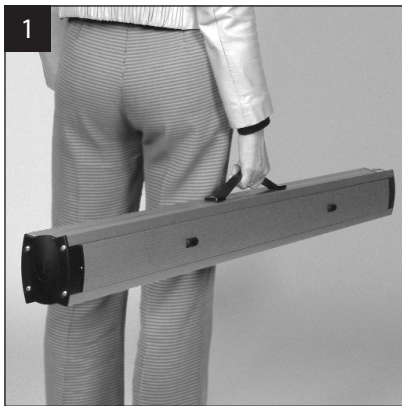

Warning



English

The standard temperature for use lies between 15 and 40 degrees Celsius. The pneumatic springs in the angled arms lose their strength at temperatures lower than 15 degrees Celsius, which means that they are no longer able to balance the projection screen in all positions. This can cause injury to hands or fingers, as the projection screen can unexpectedly fall shut.

Deutsch

Die normale Gebrauchstemperatur liegt zwischen 15 und 40 Grad Celsius. Bei Temperaturen unter 15 Grad Celsius verlieren die Gasfedern in den Knickarmen ihre Kraft. Dadurch sind sie nicht mehr in der Lage, die Projektionswand in allen Positionen auszubalancieren. Dies kann zu Verletzungsgefahren für Hände und Finger führen, weil die Projektionswand plötzlich zufallen kann.

Français

La température d'utilisation standard se situe entre 15 et 40 degrés Celsius. Les ressorts à gaz situés dans les bras de fléchissement perdent leur résistance par des températures inférieures à 15 degrés Celsius ; ils ne sont alors plus en mesure d'équilibrer l'écran de projection dans toutes les positions. Ceci peut entraîner des risques de blessures aux mains ou aux doigts, car l'écran de projection peut se refermer de manière inattendue.

Nederlands

De standaard gebruikstemperatuur ligt tussen de 15-40 graden celsius. De gasveren in de knikarmen verliezen hun kracht bij temperaturen onder de 15 graden celsius, hierdoor zijn ze niet in meer in staat om het projectiescherm in alle posities te balanceren. Dit kan gevaar voor letsel aan handen of vingers veroorzaken omdat het projectiescherm onverwacht kan dichtvallen.